

\$175/CAMPER

Economy Lodgings

Economy Lodgings do NOT have Restrooms inside.
Each cabin is located near a Shared Bathhouse

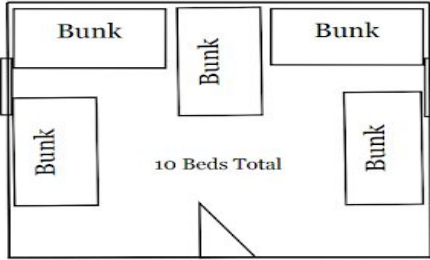

Economy Cabins

12 Cabins w/ 10 Beds Each
4 Cabin Areas
~ Mt, Bay, Lake, River ~
120 Economy Beds total

Lights & Heat
Walk to shared Bathhouse

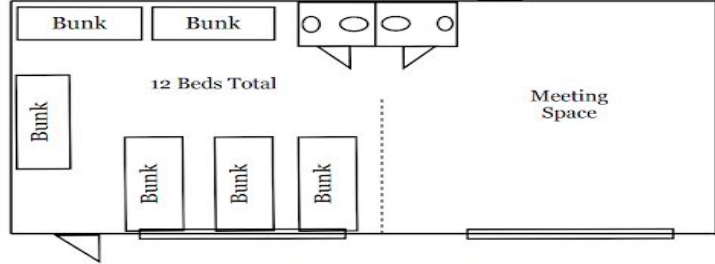

Huckleberry Cabin

6 Bunks / 12 Beds

Lights & Heat
2 Half-Baths
Walk to shared Bathhouse



Lake, River, Mt. & Bay Cabins

Occupancy: 12 cabins with 10 beds each - 4 groups of 3 (90 minimum & 120 maximum)



These 12 cabins were the first lodgings to be added after Camp Arrah Wanna opened in 1941. Since then, we have winterized each space for year-round use and upgraded them to include carpet, electricity & heat. Each set of 3 is within short walking distance of a shared bathhouse.

If you're looking for a more classic camp experience, these cabins are perfect for you and your group.

Huckleberry Bunkhouse

(Not Pictured)

Occupancy: 12 beds/6 bunks (8 minimum & 20 maximum)

This cabin has 12 beds, two ½ bathrooms and a partition that can divide the sleeping area from an open meeting space. We are happy to provide tables and chairs upon request to fit your needs! Shower facilities are located nearby in the Huckleberry bathhouse.